

TOWN AND COUNTRY PLANNING ACT 1990

Land to the North and West of School Road, Elmswell, Suffolk

Heritage Proof of Evidence
Document 2 of 2: Appendix D

Tim Murphy IHBC MCifA

July 2025

PLANNING INSPECTORATE REFERENCE:
APP/W3520/W/25/3364061
LPA Reference:
DC/23/05651

Figures

Figure 1 View of Church St John from south west



Figure 2 View of Church of St John from west (Photograph provided by Church of St John)



Figure 3 View of Almshouses from south



Figure 4 View of Elmswell Hall from south



Figure 5 Engraving of Church of St John, 1836 (located in church)



Figure 6

Early twentieth century postcard (Elmswell History Group)



Figure 7

Towards Woolpit Painting by Christopher Penny (1947-2001), looking from Elmswell towards Woolpit (Elmswell History Group)

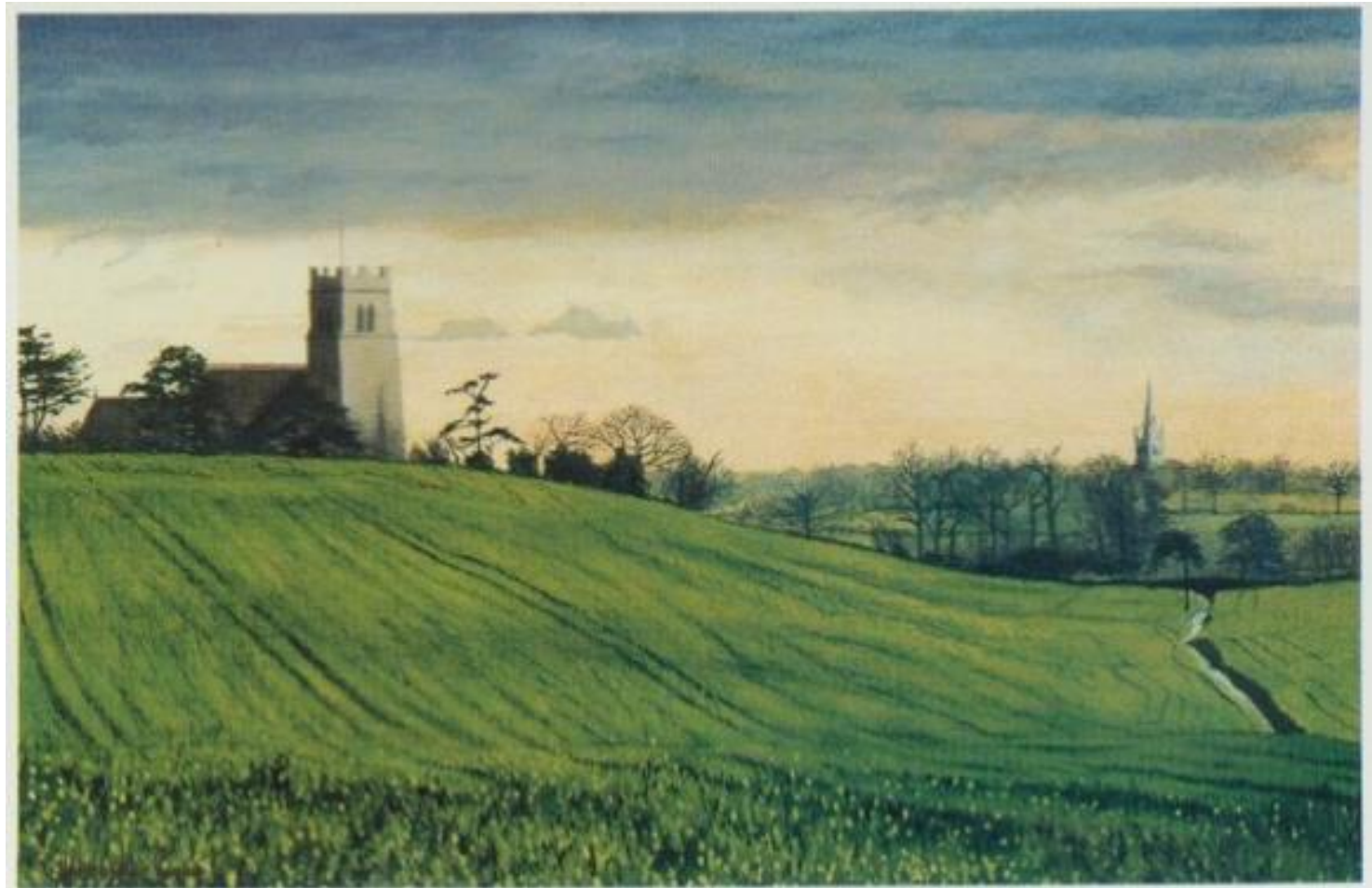

Figure 8

Postcard showing the Almshouses, 1934 (Elmswell History Group)



Figure 9

View of Church of St John (provided by church)



Figure 10 View of Church of St John (provided by church)



Figure 11 View of plaque on front elevation of Almshouses



Figure 12

View of tomb of Sir Robert Gardener in the Church of St John



Maps

Map 1

Heritage Asset Map

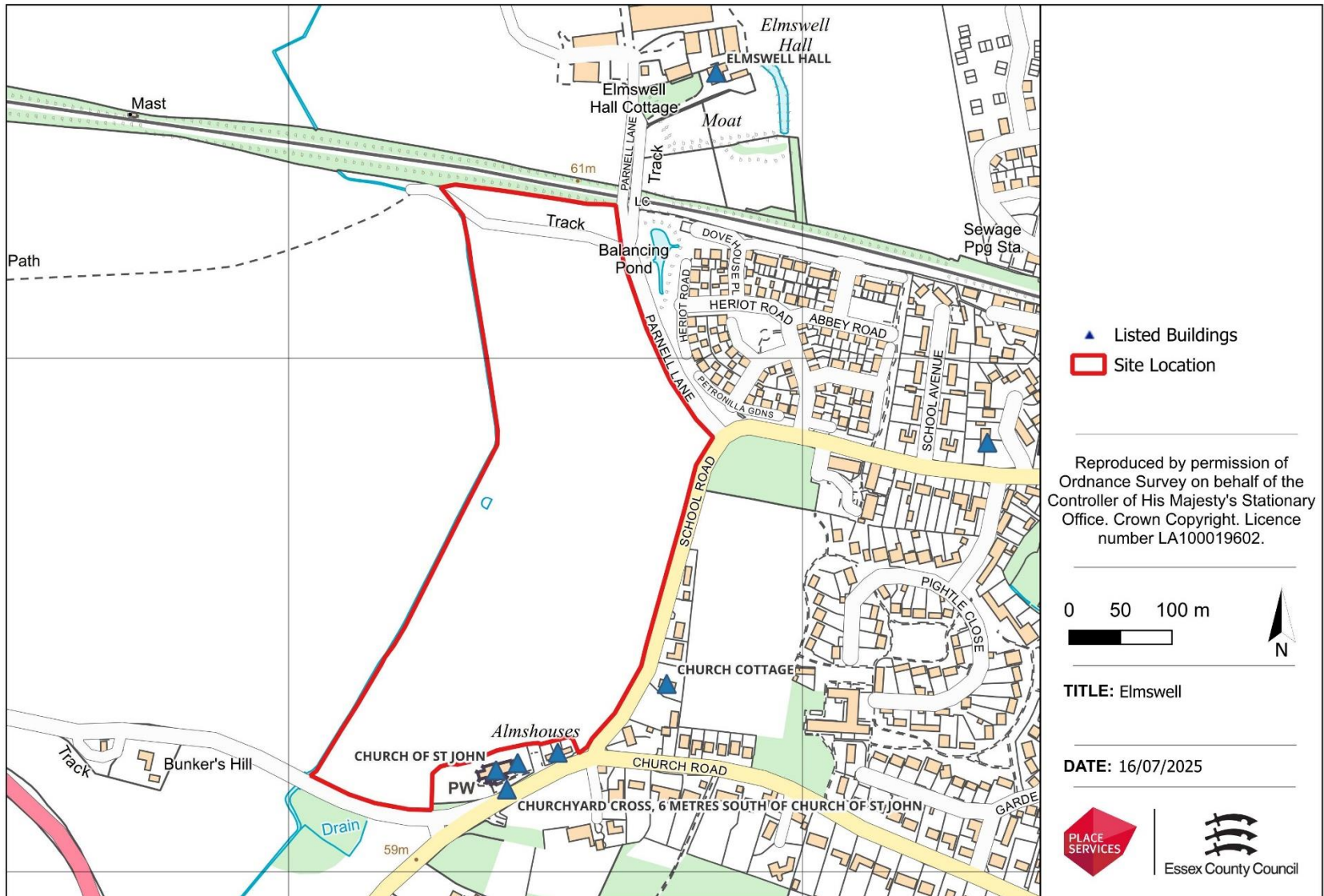

Map 2

Map showing viewpoint locations

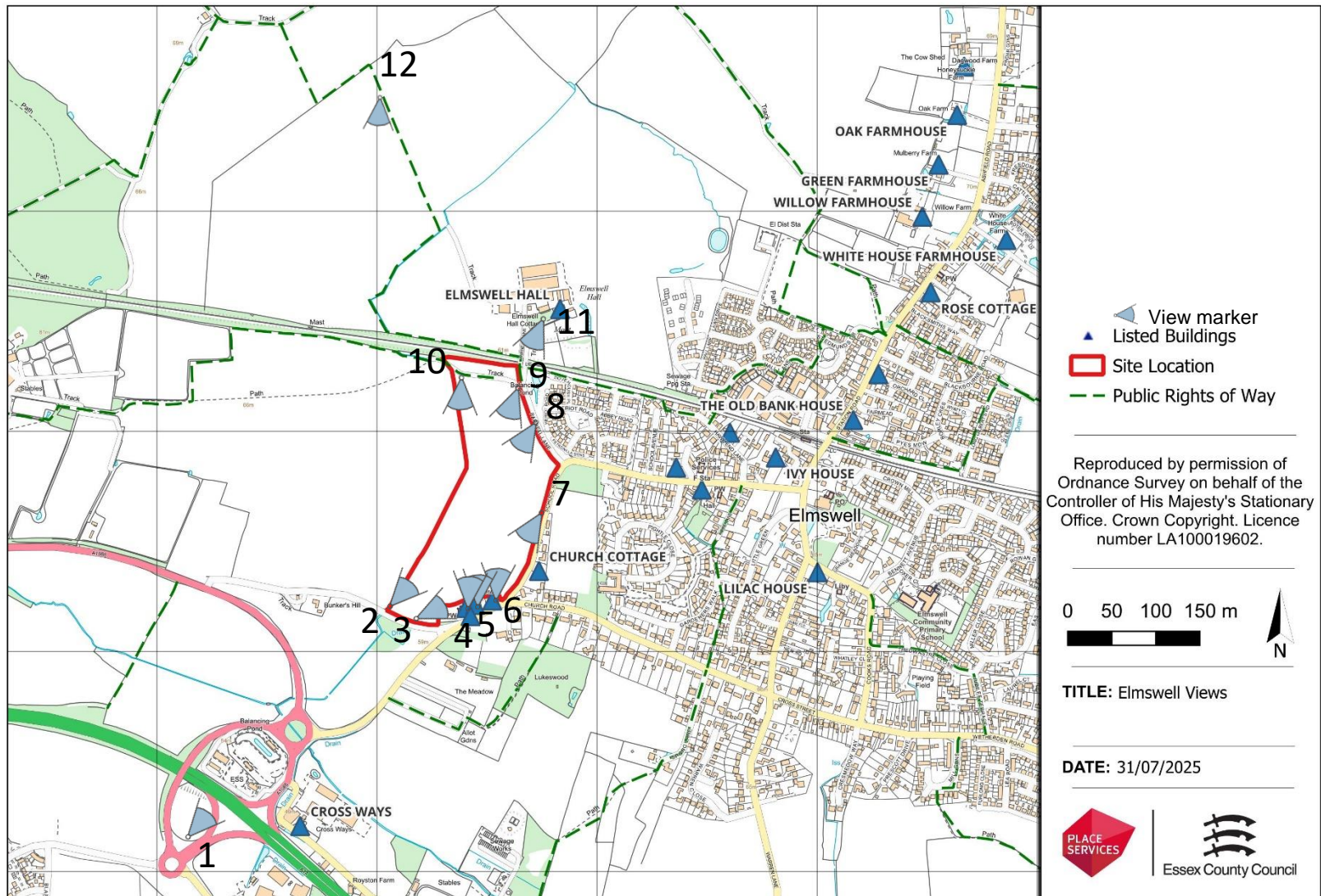

Map 3

Hodkinson's map of Suffolk, 1783

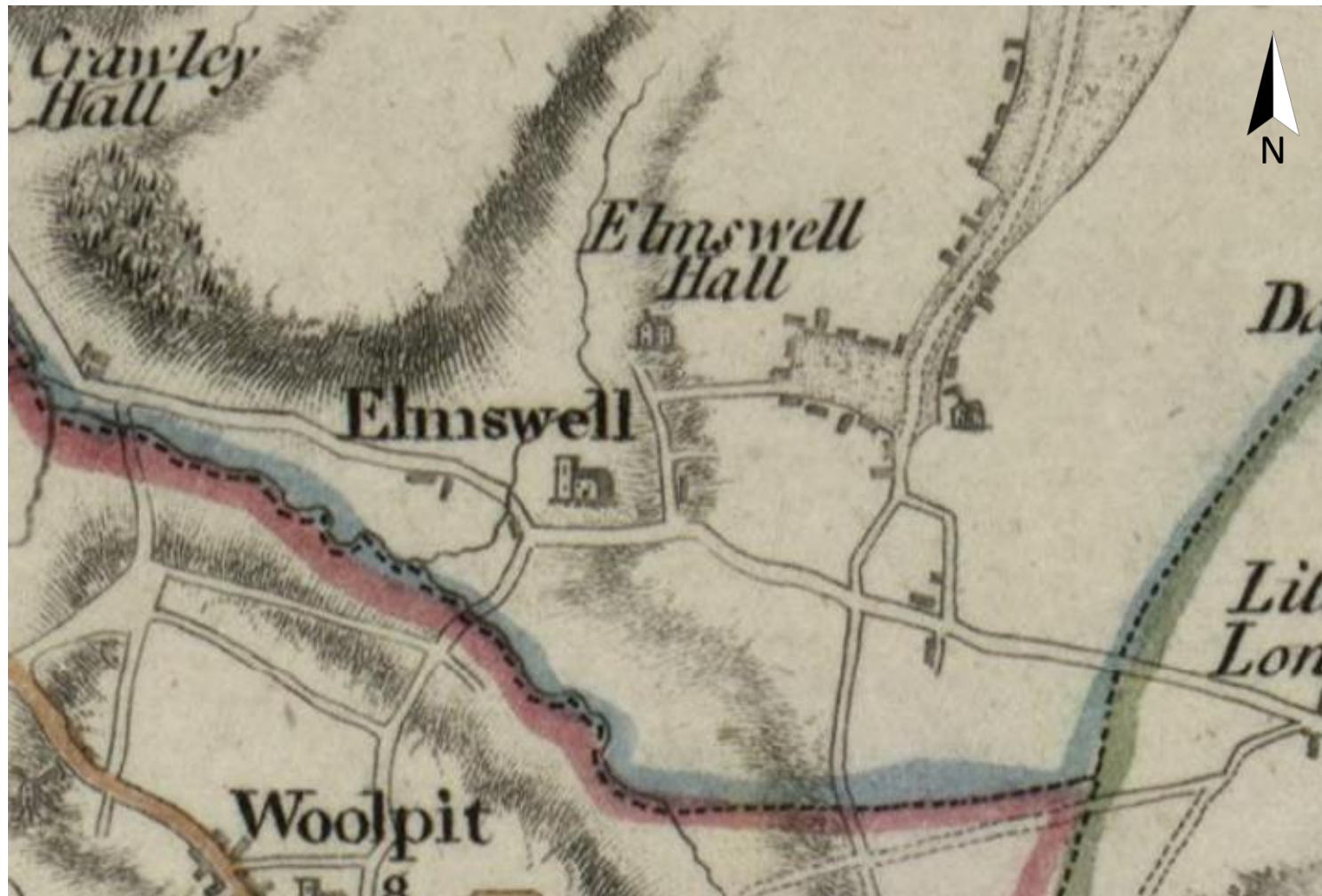

Map 4

Tithe Map c.1840.



Map 5

First Edition Ordnance Survey, 1884. Approximate site location outlined

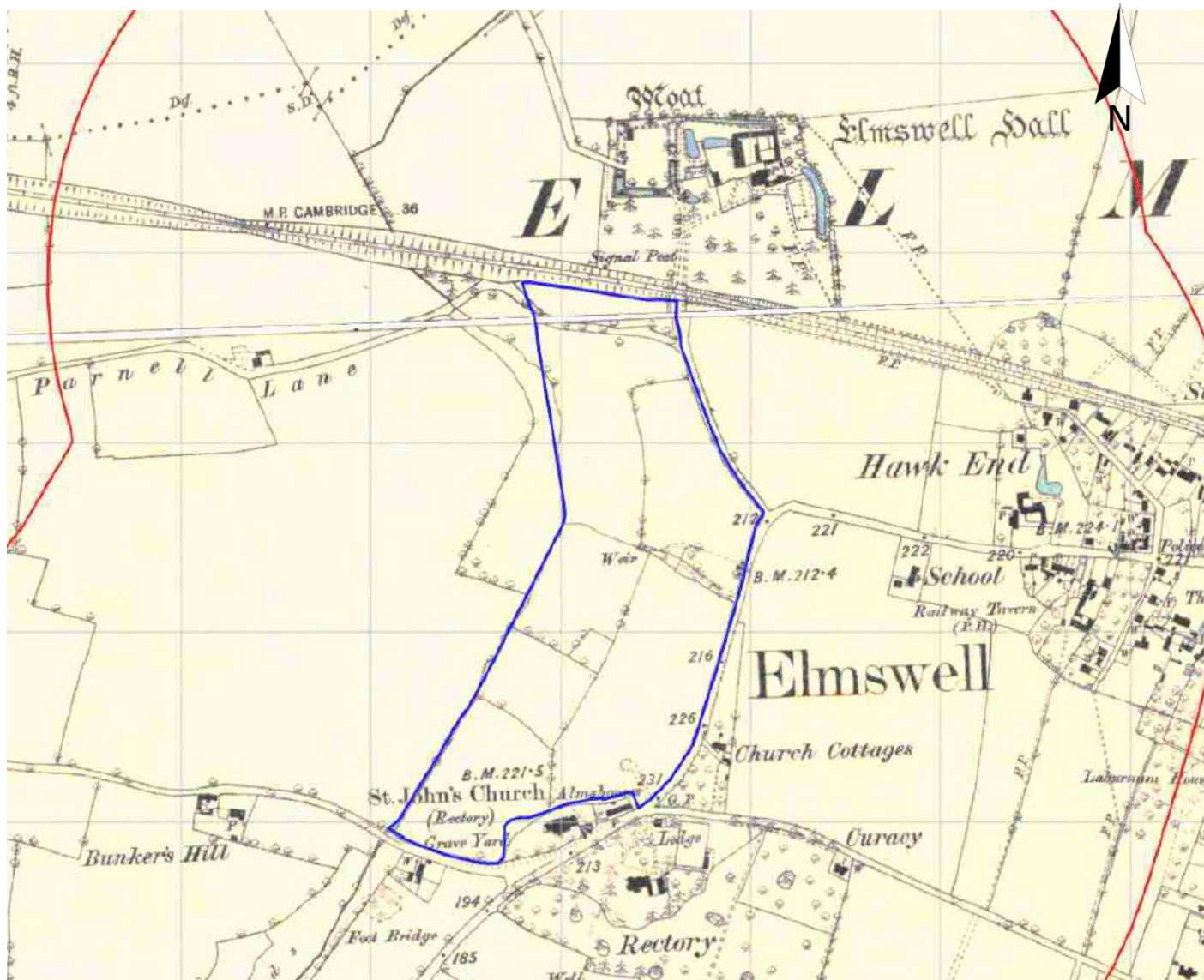

Map 6

Ordnance Survey, 1903. Approximate site location outlined

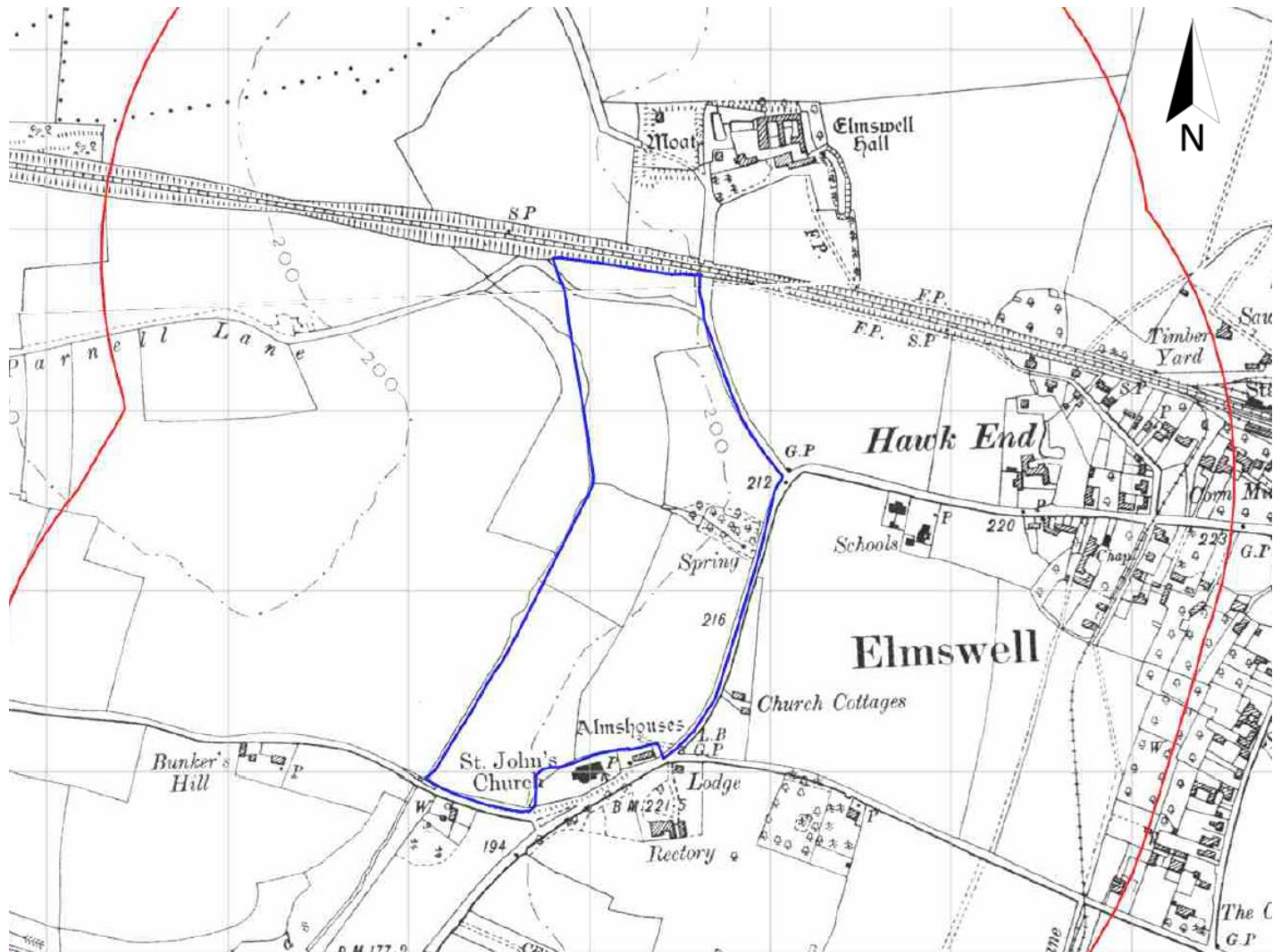

Map 7

Ordnance Survey, 1920. Approximate site location outlined

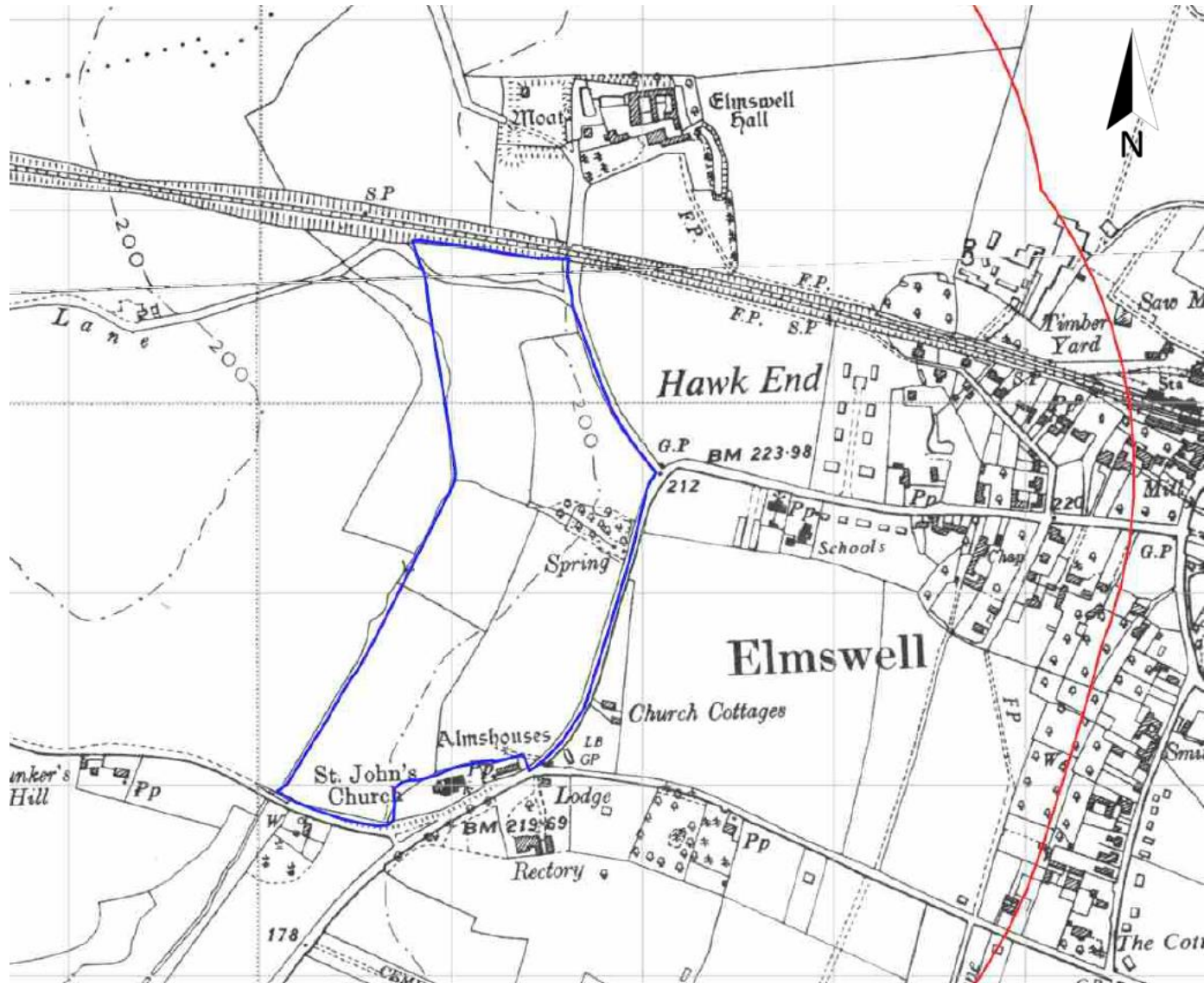

Map 8

Ordnance Survey, 1975. Approximate site location outlined

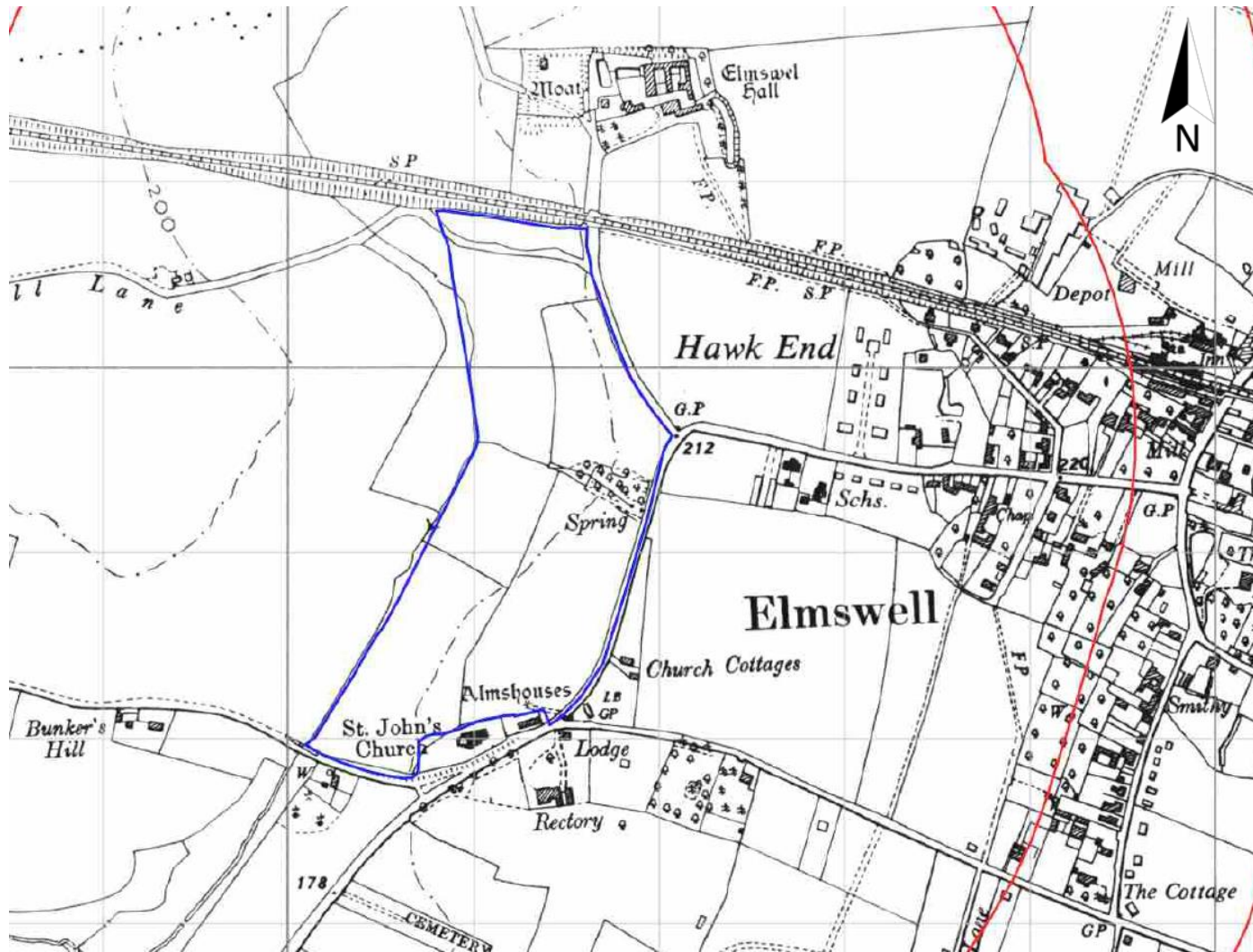

Map 9

Ordnance Survey, 1975. Approximate site location outlined

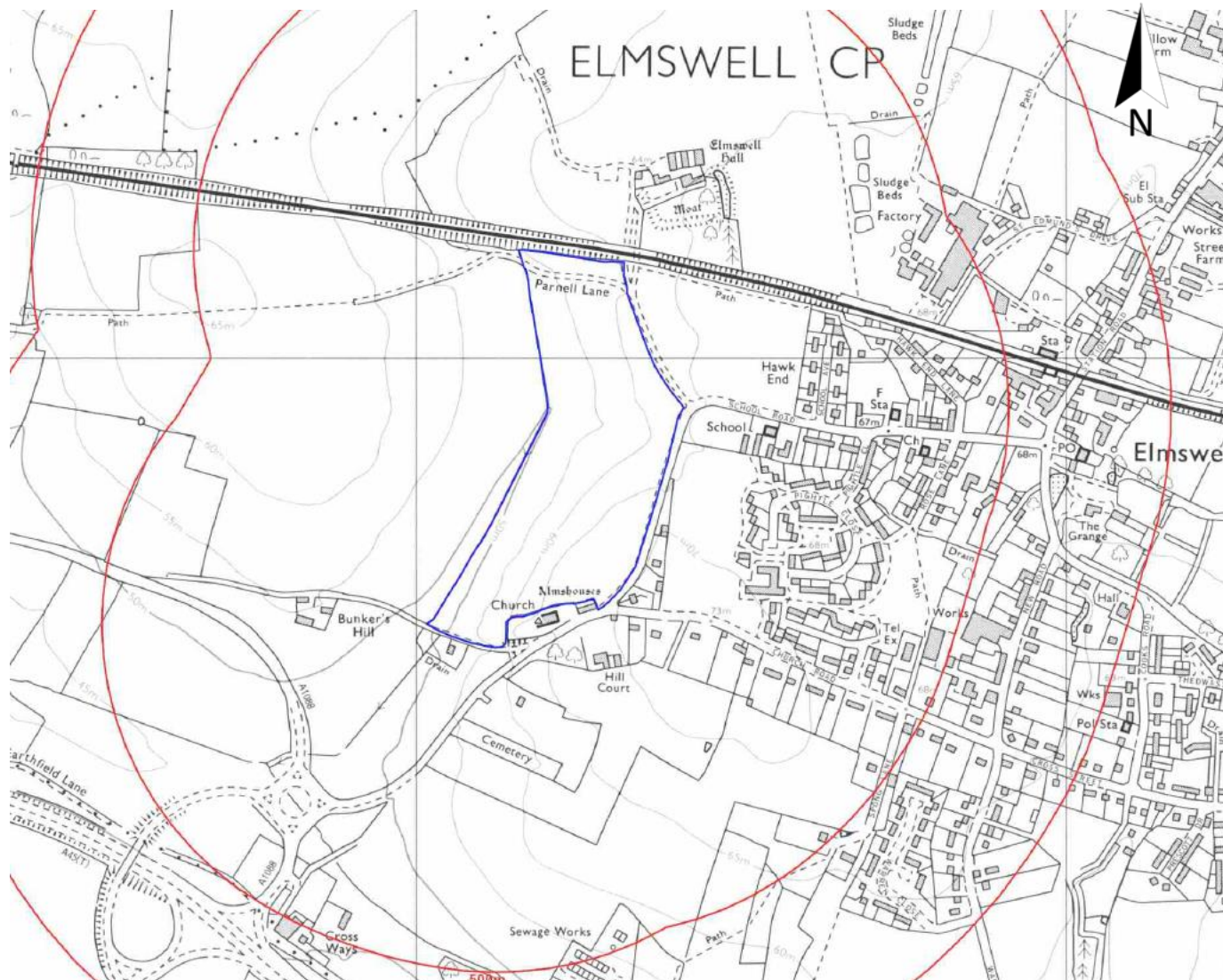

Map 10

Historic Ordnance Survey showing Church of St John and Almshouses

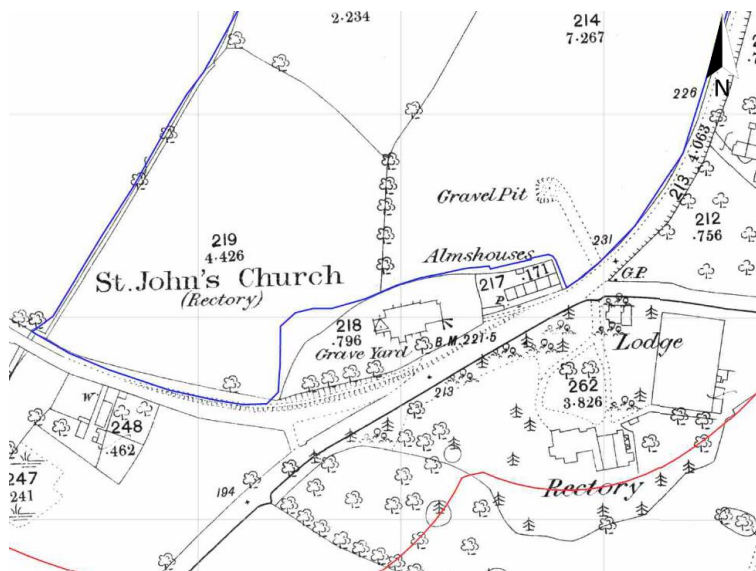

1883

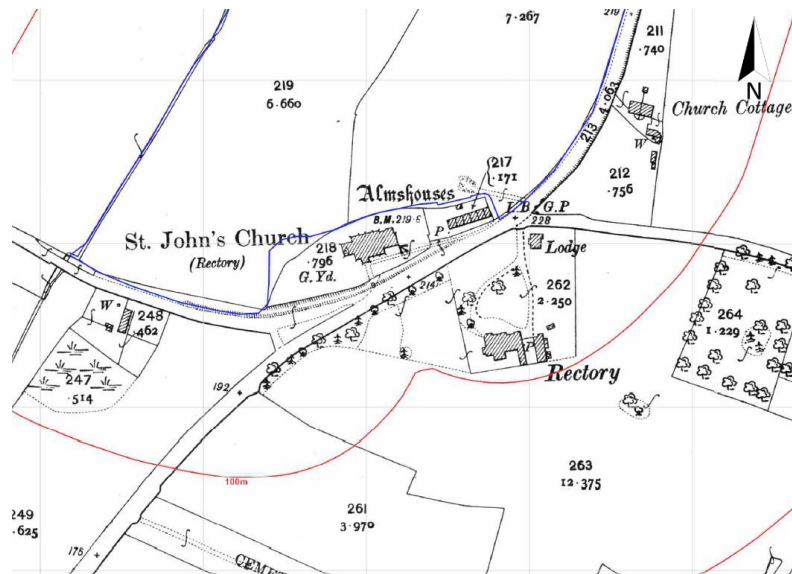

1924

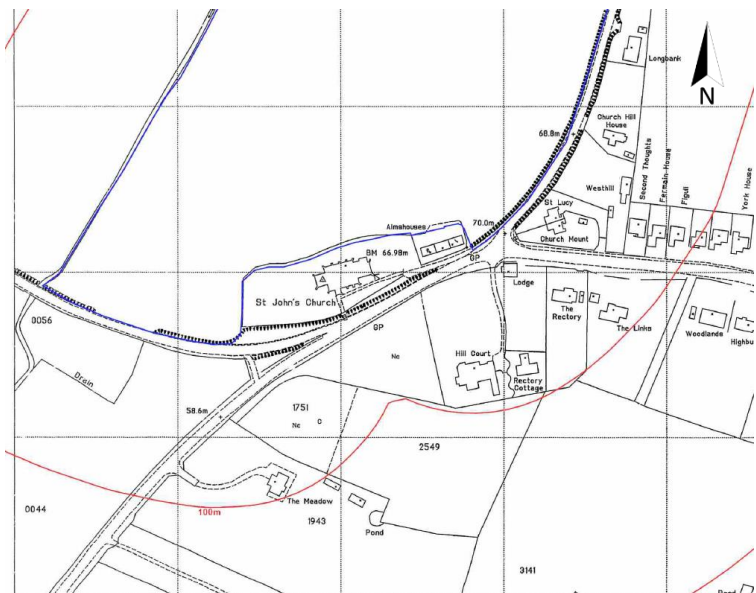

1995

Map 11 Historic Ordnance Survey showing Elmswell Hall

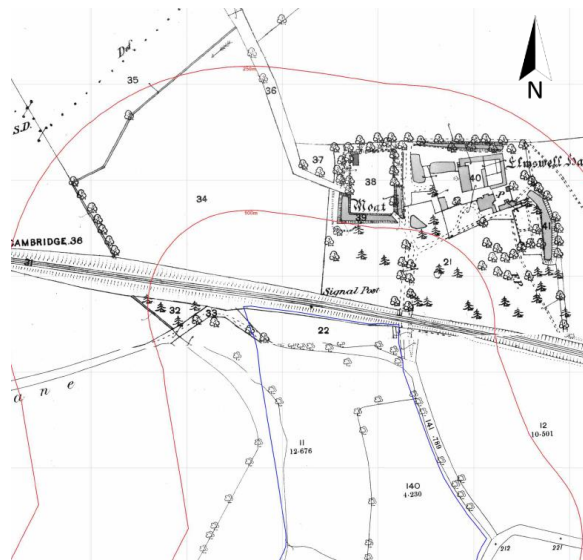

1883



1903

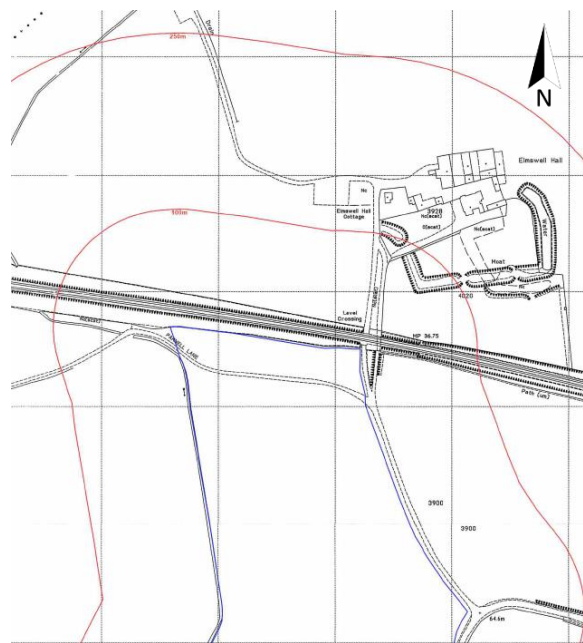

1995

Viewpoints

Viewpoint 1 View looking north east from footpath adjacent to roundabout between A1088 and Heath Road



Viewpoint 2 View looking north east on Church Lane looking towards Church of St John



Viewpoint 3 View looking north east on Church Lane looking towards Church of St John and Elmswell Hall



Viewpoint 4 View looking north from Tower of Church of St John



Viewpoint 5 View looking north from churchyard



Viewpoint 6 View looking north from gardens of the Almshouses



Viewpoint 7 View looking south west across the Site towards Church of St John and Almshouses



Viewpoint 8 View looking south west across the Site towards Church of St John and Almshouses



Viewpoint 9 View looking south across the Site towards Church of St John and Almshouses



Viewpoint 10 View looking south across the Site towards Church of St John and Almshouses



Viewpoint 11 View looking south west across the Site towards Church of St John



Viewpoint 12 View looking south towards Church of St John and Church of St Mary's in Woolpit

